

BASE UNIT PLACEMENT

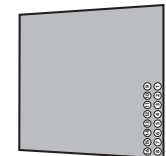
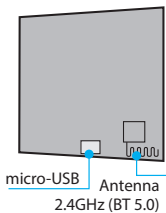
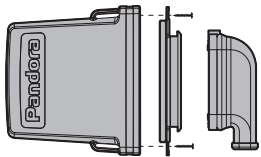
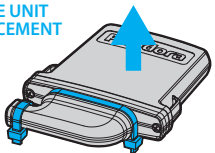

WARNING! Update firmware of the base unit before installation. If the CAN-bus connected, choose the vehicle model code.

WARNING! The installation locations of the base unit and system elements must meet their temperature, dust- and moisture-protection characteristics. The base unit and blocking relay are designed to operate at temperatures from -40°C to +85°C, the degree of protection is IP54.

WARNING! The base unit must be placed vertically or horizontally, do not cover the front side of the unit (the side with the «Pandora» sign).

WARNING! Do not shield the built-in antenna when installing the system and additional devices. Keep minimum distance of 2 cm between the modules and metal parts.

WARNING! Fixate the protective cap using clamps when the installation is finished. Isolate the protective cap and wires with the insulating tape.

WARNING! All power circuits of additional devices that are not powered through the base unit of the system should have their own fuses.

WARNING! The system is a maintenance-free device. In case of failure you must immediately contact your local supplier.

WARNING! All wireless accessories from the kit are already paired with the base unit. The maximum number of paired Bluetooth accessories is 14.

WIRING DIAGRAM

Pandora MINI MOTO

IT IS FORBIDDEN to install the system on a vehicle with normal voltage other than 12V.

IT IS FORBIDDEN to install the system with damaged output cables.

IS FORBIDDEN to change or bypass original fuses of a system in the installation process. **IT IS FORBIDDEN** to install the temperature sensor at the place where temperature is higher than the operating range of the sensor (+125°C) and cable (+80°C).

